

# FLOS

 F6496014 Blue

## String Light - Sphere head - 22mt cable

Designed by Michael Anastassiades, 2014



21W - 1515lm - 2700K

Suspension lamp providing diffused light. Black, white or blue varnished die-cast aluminium body coated with clear soft-touch varnish. Optical diffuser in opal PC. Suspension system of 22 metres with Kevlar reinforced coaxial cable. Available with wall/ceiling connection in black PC and power supply with floor switch in black varnished PC. The on/off switch is electronic with optical and touch dimm mechanism included or touch dimm and CASAMBI Ready version. Dimmer included. Compulsory to add either floor switch or ceiling/wall rose.

Are you a professional and your project needs consulting and support?

[BOOK AN APPOINTMENT](#)

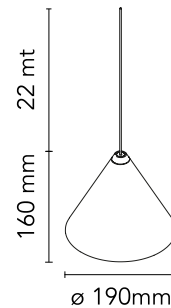

### Main specifications

|                        |                     |
|------------------------|---------------------|
| EAN                    | 8059607041550       |
| Mounting               | Suspension          |
| Environments           | Indoor dry location |
| Light source type      | LED                 |
| Light sources included | Yes                 |
| LED type               | LED array           |
| Power (W)              | 21                  |
| Lumen Output (lm)      | 1515                |

### Physical

|                     |       |
|---------------------|-------|
| Colour              | Blue  |
| Length (mm)         | 190   |
| Cord colour         | Blue  |
| Cord length (mm)    | 22000 |
| Net weight (kg)     | 1.5   |
| Package height (mm) | 300   |
| Package width (mm)  | 300   |
| Package length (mm) | 300   |
| Package volume (m3) | 0.03  |
| IP internal         | 20    |

### Download

|                       |                       |
|-----------------------|-----------------------|
| Mounting instructions | <a href="#">↓ PDF</a> |
| Mounting instructions | <a href="#">↓ PDF</a> |
| Mounting instructions | <a href="#">↓ PDF</a> |

### Photometric Files

|           |                       |
|-----------|-----------------------|
| LDT / IES | <a href="#">↓ LDT</a> |
|-----------|-----------------------|

### Technical Drawings

|   |                       |
|---|-----------------------|
|  Bim | <a href="#">↓ ZIP</a> |
|---|-----------------------|

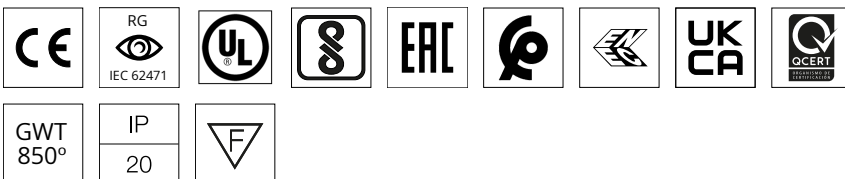

## Schematic light drawing

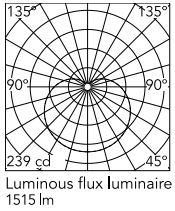

## Ecodesign and Energy Labelling

This product contains a light source of energy efficiency class D



## Photometric

|                    |                |
|--------------------|----------------|
| Lighting type      | Total          |
| Light distribution | Roto symmetric |
| CCT (K)            | 2700           |

## Electrical

|                     |                   |
|---------------------|-------------------|
| Insulation class    | III               |
| Main voltage (Vac)  | 48                |
| Forward voltage (V) | 48                |
| Power supply        | Remote excluded   |
| Dimmable            | Yes               |
| Power supply type   | Electronic 48V    |
| Dimming interface   | Dimmer Integrated |
| Batteries inside    | No                |

## Accessories & Power Supply



REQUIRED

F6482014

String Light Canopy in Blue



REQUIRED

F6484014

String Light Floor switch EU



REQUIRED

F6484314

String Light Floor switch GB



OPTIONAL

F6485014

String Light Cable

## Spare Parts

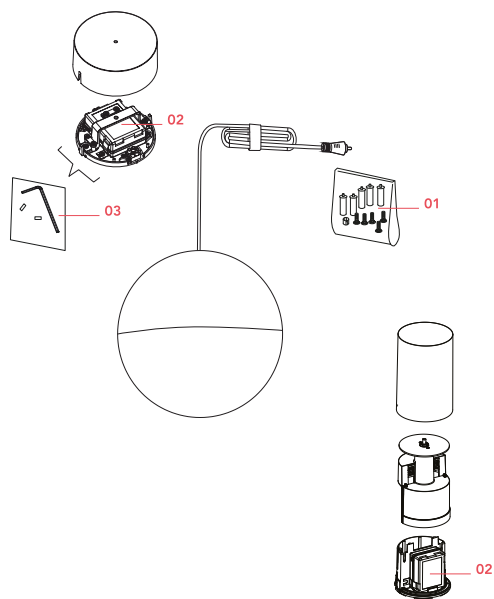

- |     |  |           |
|-----|--|-----------|
| 01. | String Light Kit with blue hooks and blue wire cable clamps          | RF6480114 |
| 02. | Power supply unit for led  | RF22934   |
| 03. | String Light Kit with allen key and screws for ceiling rose assembly | RF6480200 |

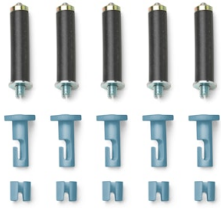

RF6480114  
String Light Kit with blue hooks  
and blue wire cable clamps



RF22934  
Power supply unit for led



RF6480200  
String Light Kit with allen key and  
screws for ceiling rose assembly