

# FLOS

03.2007.14ADA Black

## Bon Jour Ø 90 Dali

Designed by Philippe Starck, 2016



Recessed luminaire with LED light source. Remote 220/240V power supply included.

Are you a professional and your project needs consulting and support?

[BOOK AN APPOINTMENT](#)

### Main specifications

Mounting	Semirecessed
Environments	Indoor dry location
Light source type	LED
Light sources included	Yes
LED type	LED array
Lamp category	LED
Number of lamps	1
Power (W)	16
System power (W)	17.5
Source flux (lm)	2093
Lumen Output (lm)	460

### Physical

Colour	Black
Trim	Yes
Orientation	Fixed
Recessed depth (mm)	155
Bezel diameter (mm)	90
Length (mm)	90
Net weight (kg)	0.53
Package volume (m3)	0.01
IP internal	20
IP external	44

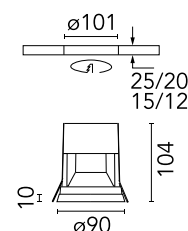

### Download

[Mounting instructions](#) PDF

### Photometric Files

[LDT / IES](#) ZIP

### Technical Drawings

[2D](#) ZIP

[3D](#) ZIP

[Bim](#) ZIP



## Schematic light drawing

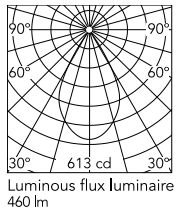

## Photometric

Lighting type	Direct
Light distribution	Symmetric
CCT (K)	3000
CRI>	90
LED Life / Failure Ratio	L80B50 > 55.000h (Tc=85°C)
Beam angle C0-180 (°)	57
Beam angle C90-270 (°)	57

## Electrical

Frequency (Hz)	50/60
Main voltage (Vac)	220-240
Forward voltage (V)	33.4
LED current (mA)	400
Power supply	Remote included
Dimmable	Yes
Power supply type	Dimmable DALI 2
Dimming range (%)	1-100
Dimming interface	Remote Dimmable (Dimmer Not Included)

## Ecodesign and Energy

### Labelling

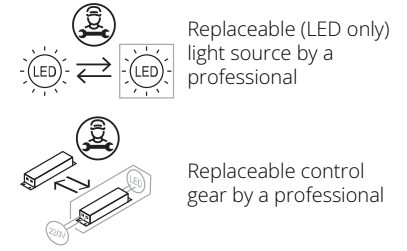

## Notes

Pre-installation frame must be ordered separately

## Accessories & Power Supply



### REQUIRED Frame

08.8974.00

Pre-installation frame



### OPTIONAL Accessory

08.8976.14

Honeycomb and cross screening  
cylinder for Bon Jour 90